



Project Name : \_\_\_\_\_ Type : \_\_\_\_\_ Date : \_\_\_\_\_ Watt : \_\_\_\_\_

Notes : \_\_\_\_\_  
\_\_\_\_\_

### **Features :**

---

- ❑ RF 2.4GHz and DMX512 CCT touch panel controller
- ❑ 4 zones and 2 programmable preferences
- ❑ Brightness control
- ❑ For architectural, commercial or residential installation
- ❑ Compatible with LS-CON-REC-4S-5A

### **Certifications :**

---

- ❑ In accord with certifications in effect in Canada and USA

### **Warranty :**

---

- ❑ The LS-CON-EMT-MUR-CCT has a 5 years warranty.

\*See our policy on our website  
[www.borealux.com](http://www.borealux.com)

**Purchase Options :**

Product Code	Input Voltage	Amp	Zones	Protocol	Metric Dimensions (L x l x h)	Imperial Dimensions (L x l x h)
LS-CON-EMT-MUR-CCT	5V DC	0,5A~1A	4	USITT DMX512	See drawings*	See drawings*

**Dimensions :**

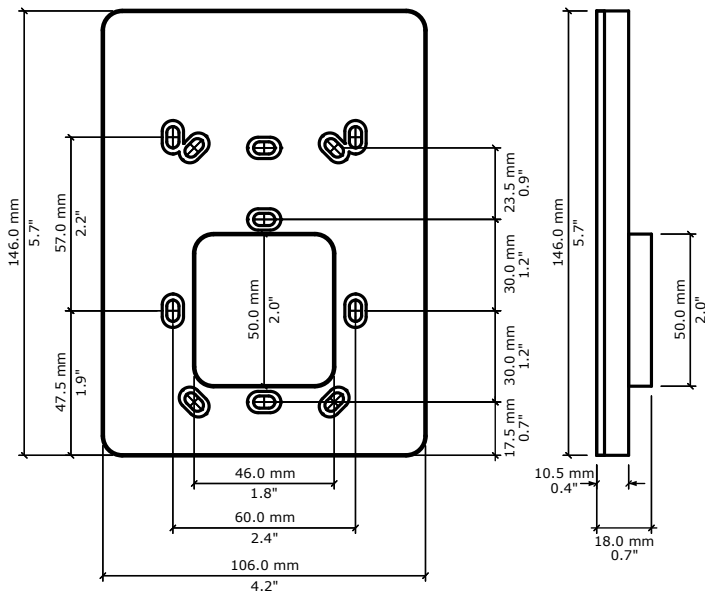

**Installations :**

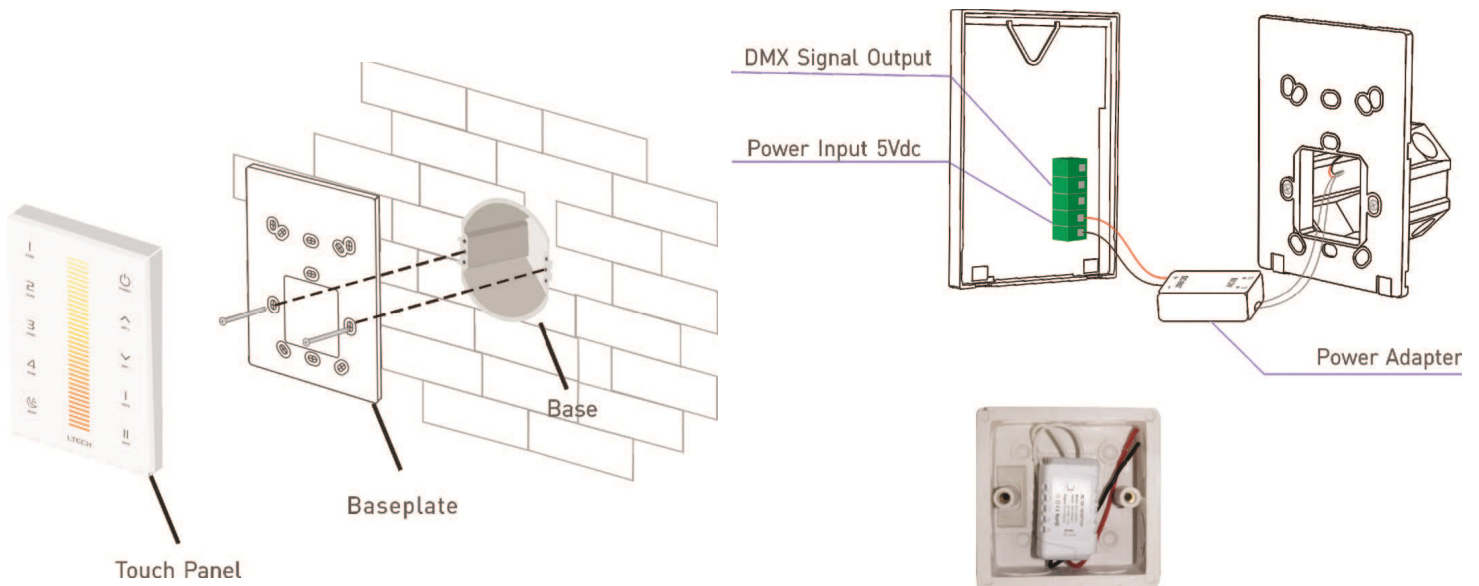

## Wiring :

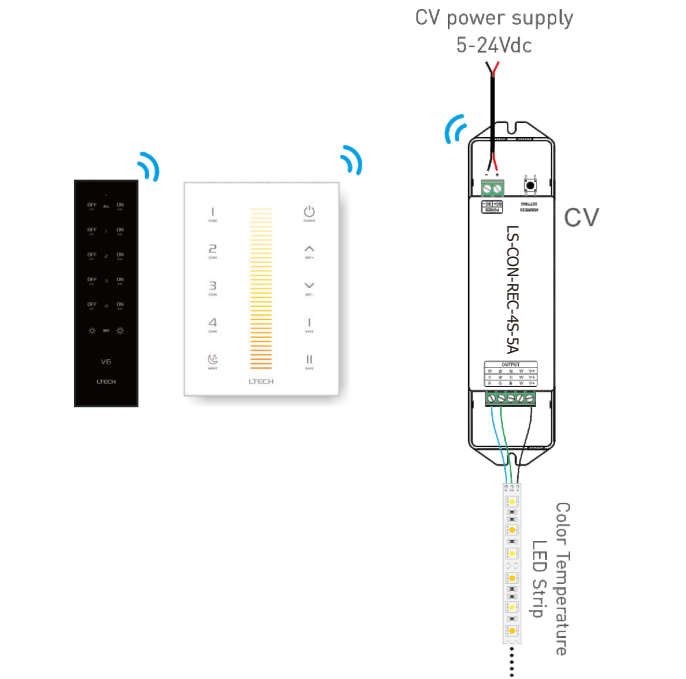

Signal Interface  
DMX RJ45



- 1: DMX+
- 2: DMX-
- 3: NC
- 4: Power
- 5: Power
- 6: NC
- 7: GND
- 8: GND

